

See how quick and easy it is
to measure your kitchen

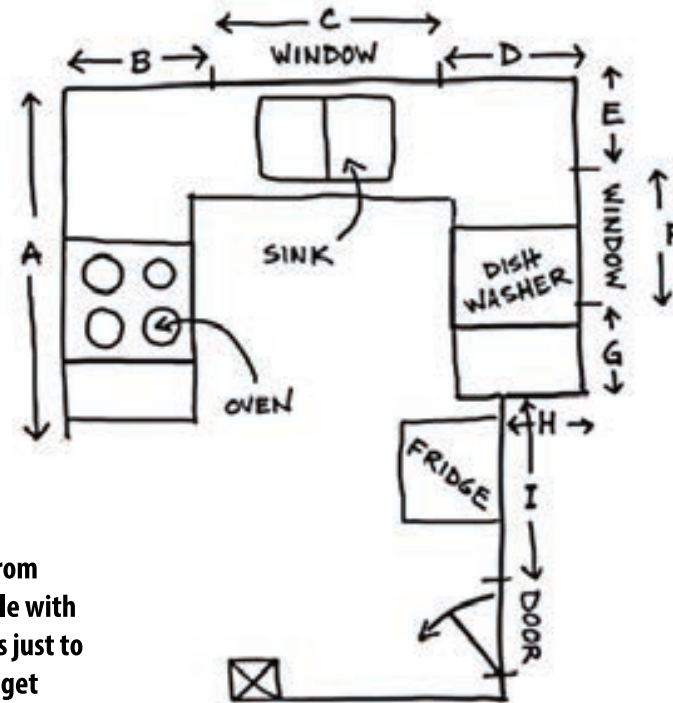

IT'S EASY

Our Measure Guide is easy to use (yes, it really is easy) and helps collect the basic information to help you and your designer start your design. This does not have to be a work of art but just a clear and accurate drawing of your space. If you want to use the attached graph paper, that's great. If not, then all we need is your drawing. We're here to help — please call 847-928-2209 with any questions.



KEY	
A	= 100"
B	= 36"
C	= 72"
D	= 36"
E	= 18"
F	= 48"
G	= 18"
H	= 12"
I	= 60"

1

Step 1: Your Kitchen Shape

Now it's time to get out the tape measure. Measure all the openings, from outside edge to outside edge, and fill in the key. If you're uncomfortable with precise measurements feel round to the nearest inch. Remember this is just to get started, free to round to the nearest inch. Remember this is just to get started, your designer will confirm details later.

2

Step 2: Draw it Out

Mark any openings such as windows and doorways. Be sure to include radiators or other obstacles that affect where cabinets can be installed. Now, label all the openings in your kitchen. In this sketch we'll use areas A thru I. Record these letters as a key on your sketch.

IT'S EASY

3

Step 1: Your Kitchen Shape

Now it's time to get out the tape measure. Measure all the openings, from outside edge to outside edge, and fill in the key. If you're uncomfortable with precise measurements feel round to the nearest inch. Remember this is just to get started, free to round to the nearest inch. Remember this is just to get started, your designer will confirm details later.

4

Step 2: Draw it Out

Most people already have a good idea of where the major items will go in their kitchen. Feel free to draw your ideas of what you would like and include the placement of your sink and appliances.

5

Step 2: Draw it Out

What can really help your designer is to take 'before' pictures of your kitchen and send them along with your measurements. That's it! You're done! It is that easy to measure your kitchen.



YOUR INFO & SKETCH

Name ----- Door Style -----

Phone ----- Designer -----

Email ----- Kitchen Ceiling Height (in inches) -----

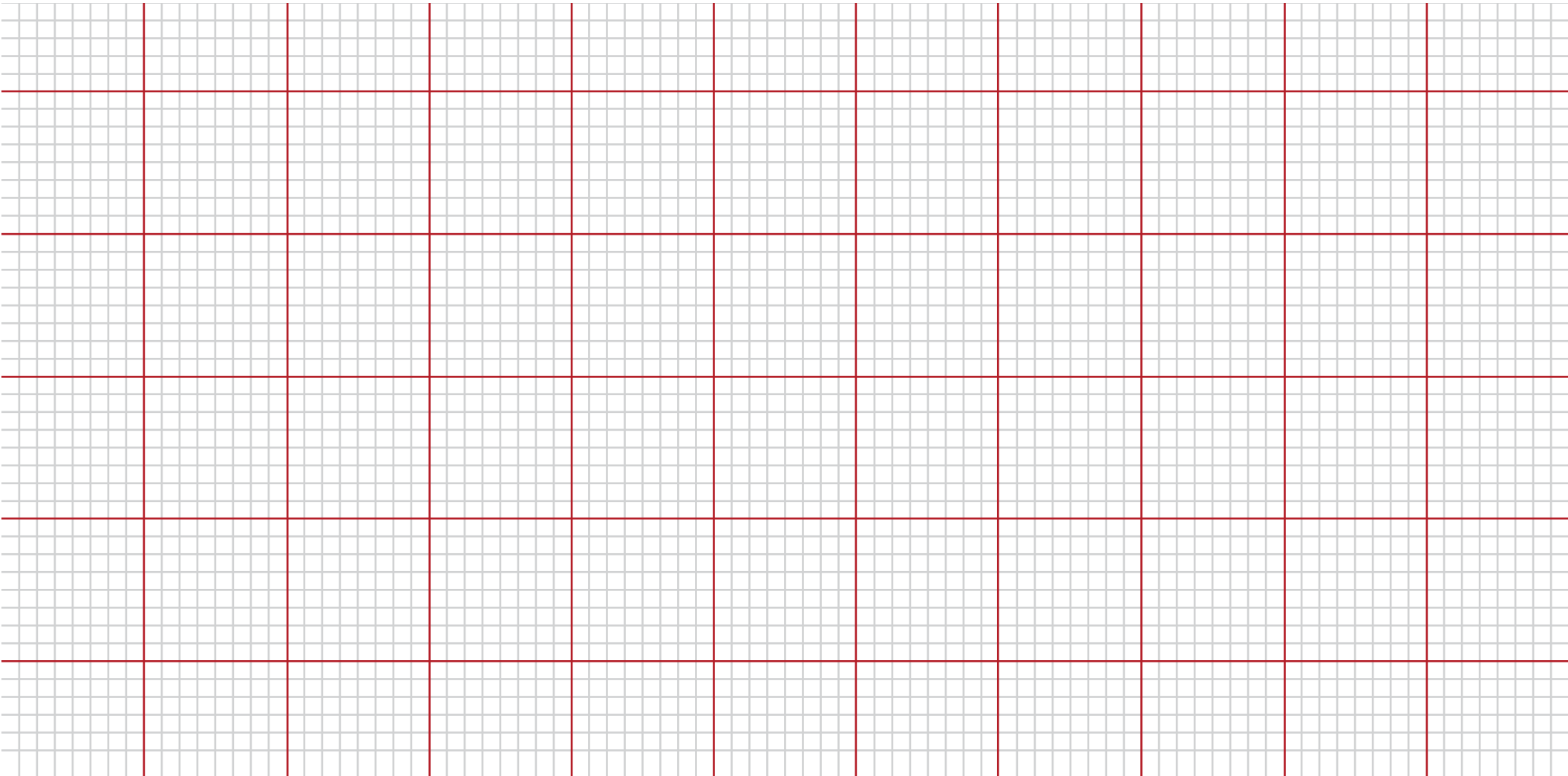

Drawing does not have to be perfect or to scale — just neat. Feel free to use any paper you want.

SEND IT TO US



SMART PHONE

Take pictures of the form and your drawing and email them to:

847-262-8341



EMAIL

15 mb max prep email, if larger please submit multiple emails.

quotes@amfcabinets.com



EMAIL

Use the web from at:

www.amfcabinets.com/get-a-quote/



Dont forget pictures!

A picture is worth a thousand words.
Send them a long with your drawing.

